

CIN NO: U29210GJ2013PTC-077779

 +91 75748 52560 / +91 99049 78000

 info@sagaraquaculture.com

 www.sagaraquaculture.com
Sagar Aquaculture Pvt. Ltd.

Aerators & Aquaculture Equipments

 Plot No. 1, Survey No 1084,
 Ardoi-Kotda Sangani Road, Village: ARDOI-360030
 Ta.: Kotda Sangani, Dist.: RAJKOT (Gujarat) INDIA

1 HP Paddle Wheel Aerator - STD - B12 Specification Sheet

Finish Product Picture



Spare Parts Product Table

Item	Parts Name	Quantity /Set	Sort Specification
1	Motor	1	IE Class - 2 ISI mark Motor With CED Coating and F Class Insulation
2	Gear Box	1	Bevel - Helical Type Gear Box With CED Coating
3	Movable Joint	2	Stainless Steel - 304 with High Quality Rubber
4	HDPE Float	2	Virgin HDPE with UV
5	Impeller	2	Virgin Plastic with UV
6	HDPE Cover	1	Virgin HDPE with UV
7	Shafting	2	Stainless Steel - 304 L Sleeve with inside Solid Iron Road
8	SS Frame	1	Stainless Steel - 304 L Angle
9	Tripode	2	Virgin Plastic with UV
10	SS Blot Kit	1	Stainless Steel - 304
11	Gear Box Oil	1	Synthetic Gear Box Oil

Product Installation Diagrams

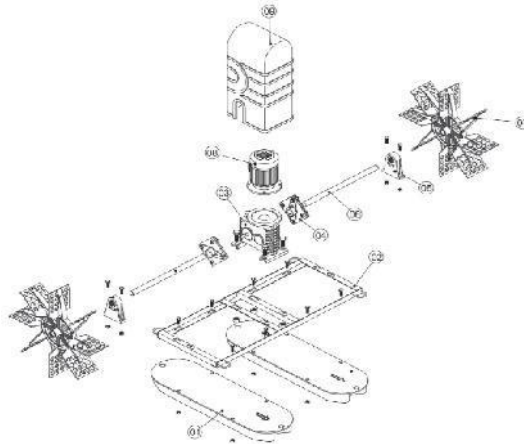

Model	KW	HP	VOLTAGE	HZ	POWER EFFICIENTY	DO	AMP	WEIGHT
STD - B12	0.75	1	210 & 415	50 & 60	0.727 Unit/Hr	1.4-1.6	1.4	80

Product Use

1HP Paddle Wheel Aerator - STD - B12 is specially design for extensive & modified extensive Shrimp/ Prawn & Fish Aqua Culture. It helps to increase DO concentration during pond culture & it also helps for removed temperature stratification in the daytime and eliminated oxygen gradient in the nighttime. Paddle Wheel Aerator create good water current (Flow) in the pond so, every time it clean Feeding Path and due to water current all feed waste & Animal Waste move to the pond center area.

Ideal position of Paddle Wheel Aerator in Pond

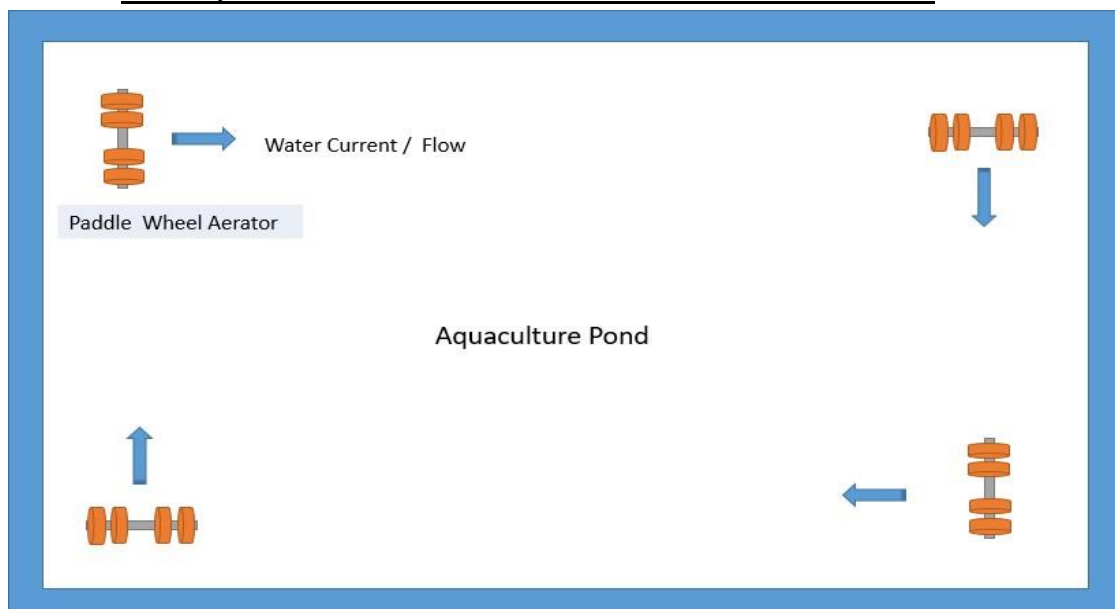

Parts Specification Sheet

1. Motor 1 HP



Rated Power : 0.75KW
Phase: 1 Phase / 3 Phase
Voltage: 210V / 415V
Rated Frequency: 50Hz/60Hz
Speed(RPM):1440
Motor Body: Casting Body With CED Coating
Insulation: F-Class
Color: Epoxy Dark Grey

- ISI Mark heavy duty IE Class - 2 Motor having IP65 Standard to protect motor from water and dust.
- Motor Body having four layer as Casting, CED Coating, Epoxy Primer and Double Coated Epoxy colour for protect motor from Rust and Corrosion with long life more than 3 years.
- F-Class insulation protects motor. If temperature goes high, motor will not heated.
- We are using High Quality SKF Bearing for long life of bearing and smooth running.
- Our motor body casting is High Presser molding system, it design gives beautiful look and generate low Heat
- Stator made by silicon grad sheet with progressive cutting die for low AMP consumption
- Rotor made by pressure die casting for better finishing & big air fins so, motor Temp. keep cool.
- Motor fan is make by nylon with glass feel material so, Fan never get burn or melt.

2. Bevel Gear Box



RPM : 106
Reducing Ratio : 1:13
Gear Type: Bevel & Helical
Body : Cast Iron Body With CED Coating
Shaft OD : 25.4mm
Shaft: SS304
Color: Epoxy Dark Grey

- Due to Bevel type gear box, it's saving 20% power consumption compare to Warm type gear box.
- Gearbox Body having four layer as Casting, CED Coating, Epoxy Primer and Double Coated Epoxy colour for protect Gear Box from Rust and Corrosion for long life more than 3 years.
- We Provides External sleeves to protect water go inside. Due to this protection gears life will be long.
- Our gear body machining done by HMC machine for accurate Fitting & perfect output.
- All bearings are HCH, it gives more life to gearbox and support for Smooth Running.
- 100% gear box pass throw noise level testing and water leakage testing for best Quality.

3. Stainless Steel Movable Joint



Material : SS - 304 with 10% Nickle
Rubber : High Quality 15mm thick rubber
Bolt : SS - 304

- Due to SS - 304 Casted movable joint - it don't get rust
- Due to Heavy Quality Rubber it is has long life
- Due to SS - 304 Bolt it can open easily after every season (After Harvesting)

Parts Specification Sheet

4. HDPE Float



Material : HDPE Virgin

Weight : 6.5 to 6.8 KG

colour: Silver

Length : 174 CM (5 Feet 8.5")

Width : 33.02 CM (13")

Height : 20.32 CM (8")

- Due to Heavy Weight , we provide enough thickness to all side wall for long life
- By adding 4% UV float get protection for direct sunlight
- Silver colourfloat make our product unique from others company common blue colour

5. Impeller

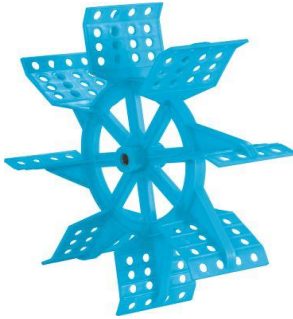

Material : Virgin PP

Weight : 2.4 KG

Bush : Brass

Die : 68 CM

Width : 19.8 CM

Color: Sky Blue

Type : Single Mould - Undetectable

- Due to Single Unit Impeller, it's create more water flow and spread more water
- Brass bushing protect from rust
- Due to high technical Impeller Design, our aerator provide best performance
- By adding 4% UV float get protection for direct sunlight
- Sky Blue colourwith silver float combination give very attractive look

6. HDPE Gear - Motor Cover



Material : HDPE Virgin

Weight : 2.3 to 2.4 KG

colour: Silver

Length : 32 CM

Width : 24 CM

Height : 65.5 CM

- Due to Heavy Weight , we provide enough thickness to all side wall for long life
- By adding 4% UV float get protection for direct sunlight
- Silver colourfloat make our product unique from others company common blue colour

Parts Specification Sheet

7. Shafting

	Material : SS - 304 L sleeve with Solid Iron Road
	Weight : 3.8 to 4.2 KG
	Grow : Made by HMC Machine
	Die : 25.4 MM
	Length : 56CM
<ul style="list-style-type: none"> • Due to SS 304L 1.5mm thick Sleeve 100% rust proof • Due to inside solid Iron Bar, it very heavy & it has long life. 	

8. Stainless Steel Frame

	Material : SS - 304 Original L Angle
	Weight : 6.5 KG
	Colour: Powder coating for better look
<ul style="list-style-type: none"> • Due to Original L Angle, it is very heavy duty frame & it give good stability to Aerator in running condition • SS 304 material with Powder Coated Frame from Rust. 	

9. Tripode

	Material : Virgin Plastic With UV
	Weight : 0.3 KG
	Colour: Silver
<ul style="list-style-type: none"> • By adding 4% UV with Nylon our Tripode get Protection for direct sunlight. 	

10. SS Bolt Kit

	Material : Stainless Steel - 304
	Bolt : 18 Pcs.
	Nut: 18 Pcs.
	Washer : 34 Pcs.
<ul style="list-style-type: none"> • Due to SS - 304 material it is rust free and long life. 	

11. Gear Box Oil

	Material : Mineral base Synthetic Oil
	Company: HP EP Parthenon - 320
	Volume : 1.5 Litre
<ul style="list-style-type: none"> • We provide gear box oil with our aerator set so, client do not need to buy from local market 	